

MALDIVES LAND SURVEY AUTHORITY

MINISTRY OF HOUSING AND INFRASTRUCTURE
 Office (PABX): +(960) 3004300, Fax: +(960) 3004254
 Email: survey@housing.gov.mv
 Web: www.surveyofmaldives.gov.mv,
 Ameenee Magu, Maafannu, Male', 20392, Maldives.



CONTROL POINT DETAILS	Station Number	PSM 5890
Coordinate Information		
Geodetic	Grid	
WGS 84	UTM Zone 43	
Lat: 5°26'25.60360"N	E: 346068.085m	
Long: 73°36'38.04992"E	N: 601527.786m	
Ellp Height: -107.196	Orth Height: +1.227	
Island Name: Lh.Meyyafushi, Maldives	Date: 13th February 2023	

Monument description & method of survey:

- Monument Type A as in Technical Brief
- Stainless steel plate fixed to concrete by Four bolts
- Horizontal coordinates fixed by GNSS Static survey.
- Elevation reduced relative to ellipsoid height difference, reference to PSM 5891 which was corrected to Meanwater level by tide prediction table (Hulhule)
- PSM 5890 is 0.20m below ground Level

General site condition & access:

- Easily accessible area with wide angle of sky visibility
- Located at South East side of the island near staff Toilet.
- Situated 4.63 m away from the east corner of the Toilet.

Owner: MUNI ENTERPRISES PVT LTD

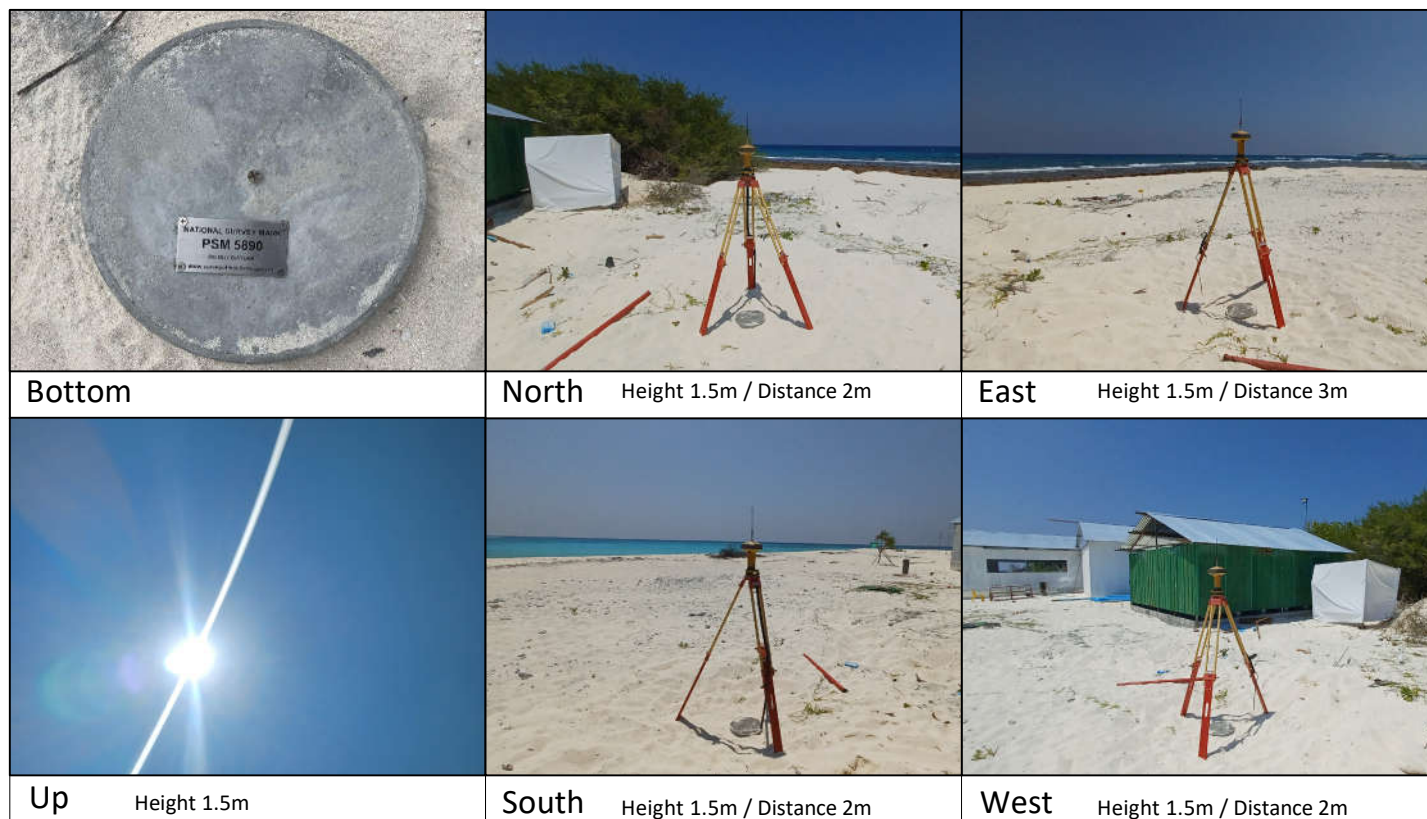

SITE INFORMATION

Station Number

P	S	M	5	8	9	0
---	---	---	---	---	---	---

Station Horizon Mask

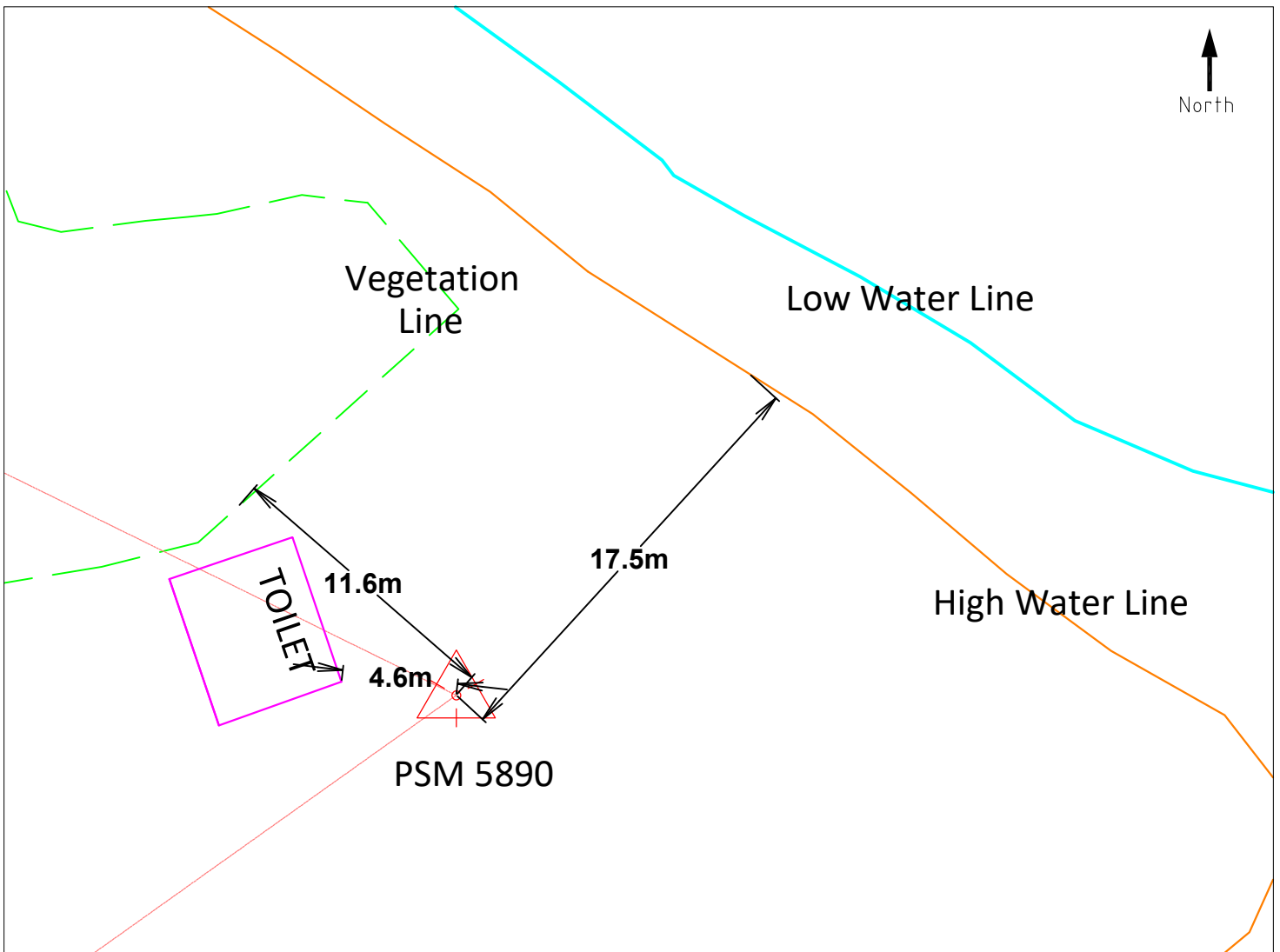
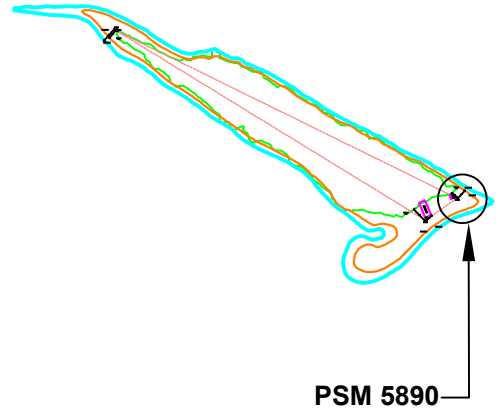
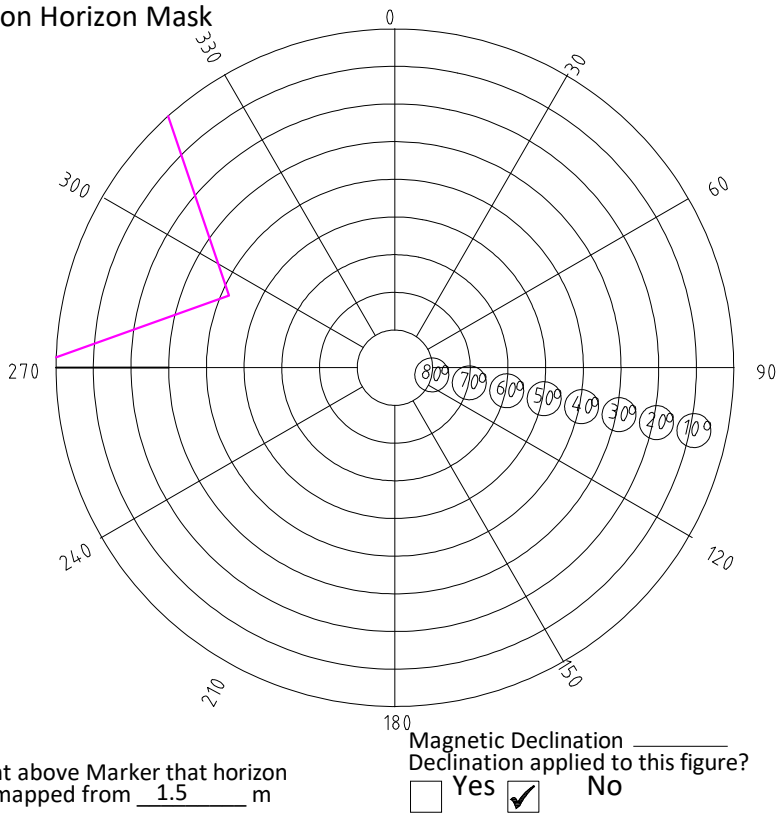

Sketched by: AHMED

Scale: Not to Scale

Date: 13 th February 2023

MALDIVES LAND SURVEY AUTHORITY

MINISTRY OF HOUSING AND INFRASTRUCTURE
 Office (PABX): +(960) 3004300, Fax: +(960) 3004254
 Email: survey@housing.gov.mv
 Web: www.surveyofmaldives.gov.mv,
 Ameene Magu, Maafannu, Male', 20392, Maldives.



CONTROL POINT DETAILS	Station Number	PSM 5891
Coordinate Information		
Geodetic	Grid	
WGS 84	UTM Zone 43	
Lat: 5°26'24.44052"N	E:	346018.043m
Long: 73°36'36.42681"E	N:	601492.178m
Ellp Height: -106.740	Orth Height:	+ 1.683
Island Name: Lh.Meyyafushi, Maldives	Date:	13th February 2023

Monument description & method of survey:

- Monument Type A as in Technical Brief
- Stainless steel plate fixed to concrete by Four bolts
- Horizontal coordinates fixed by GNSS Static survey.
- Vertical height corrected using tide prediction data (Hulhule)
- PSM 5891 is 0.30m below ground Level

General site condition & access:

- Easily accessible area with wide angle of sky visibility
- Located at the South West side of storage Building
- Situated 4.43m away from West side of Storage Building

Owner: MUNI ENTERPRISES PVT LTD

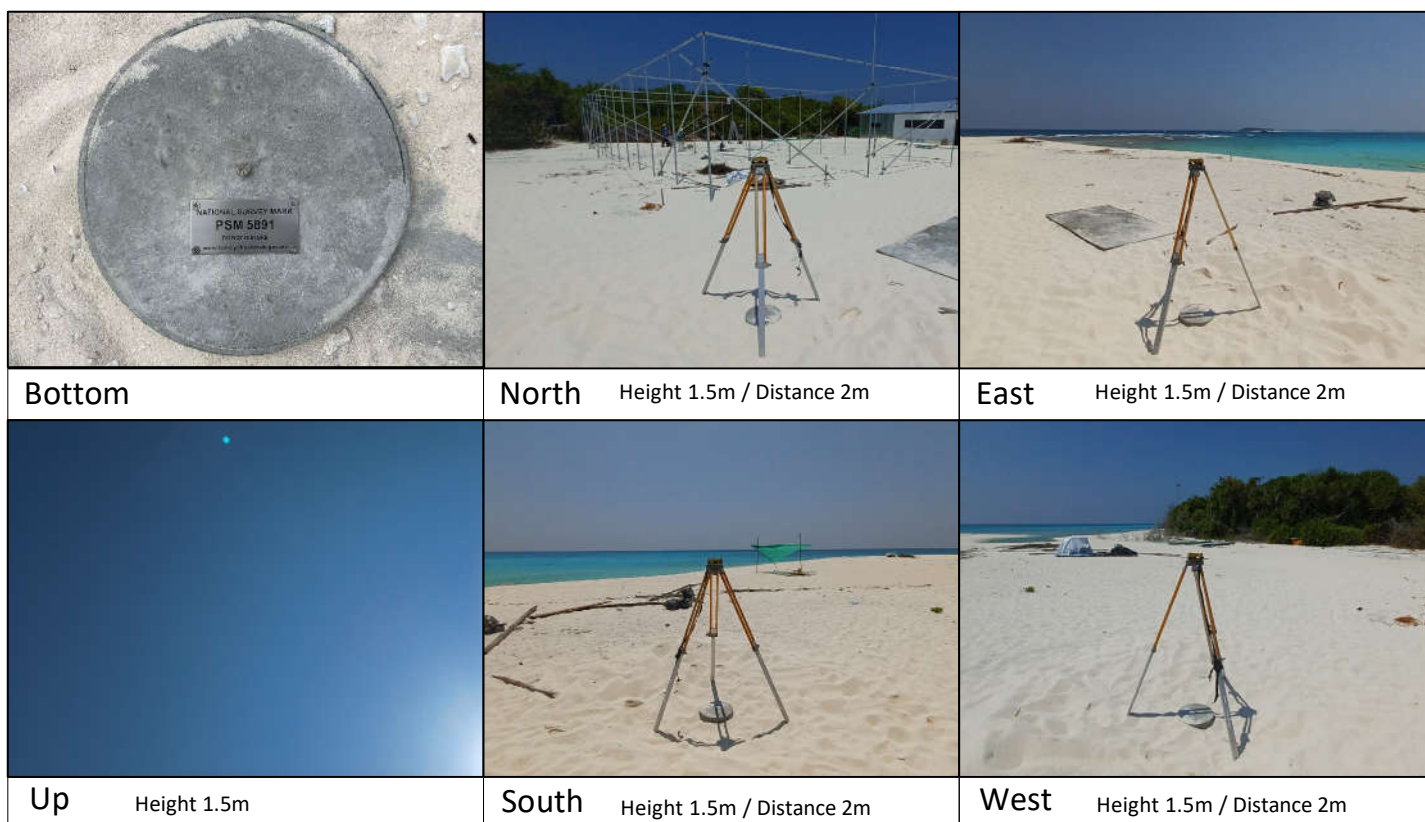

SITE INFORMATION

Station Number

P	S	M	5	8	9	1
---	---	---	---	---	---	---

Station Horizon Mask

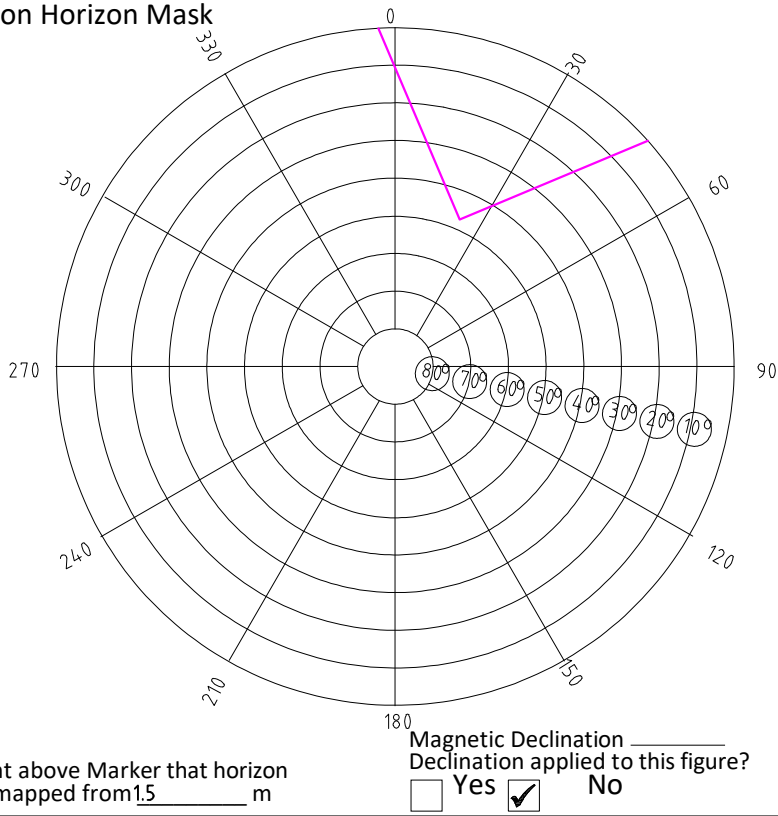

Height above Marker that horizon was mapped from 1.5 m

Magnetic Declination _____
 Declination applied to this figure?
 Yes No

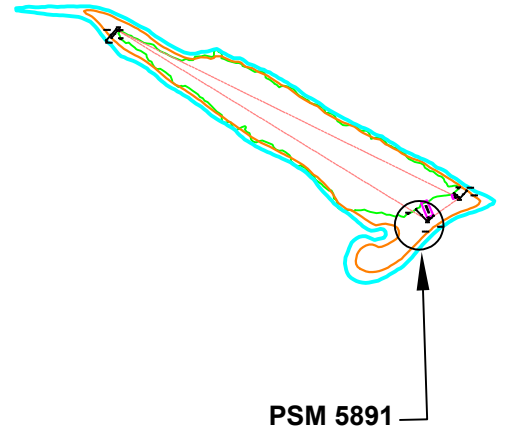

PSM 5891

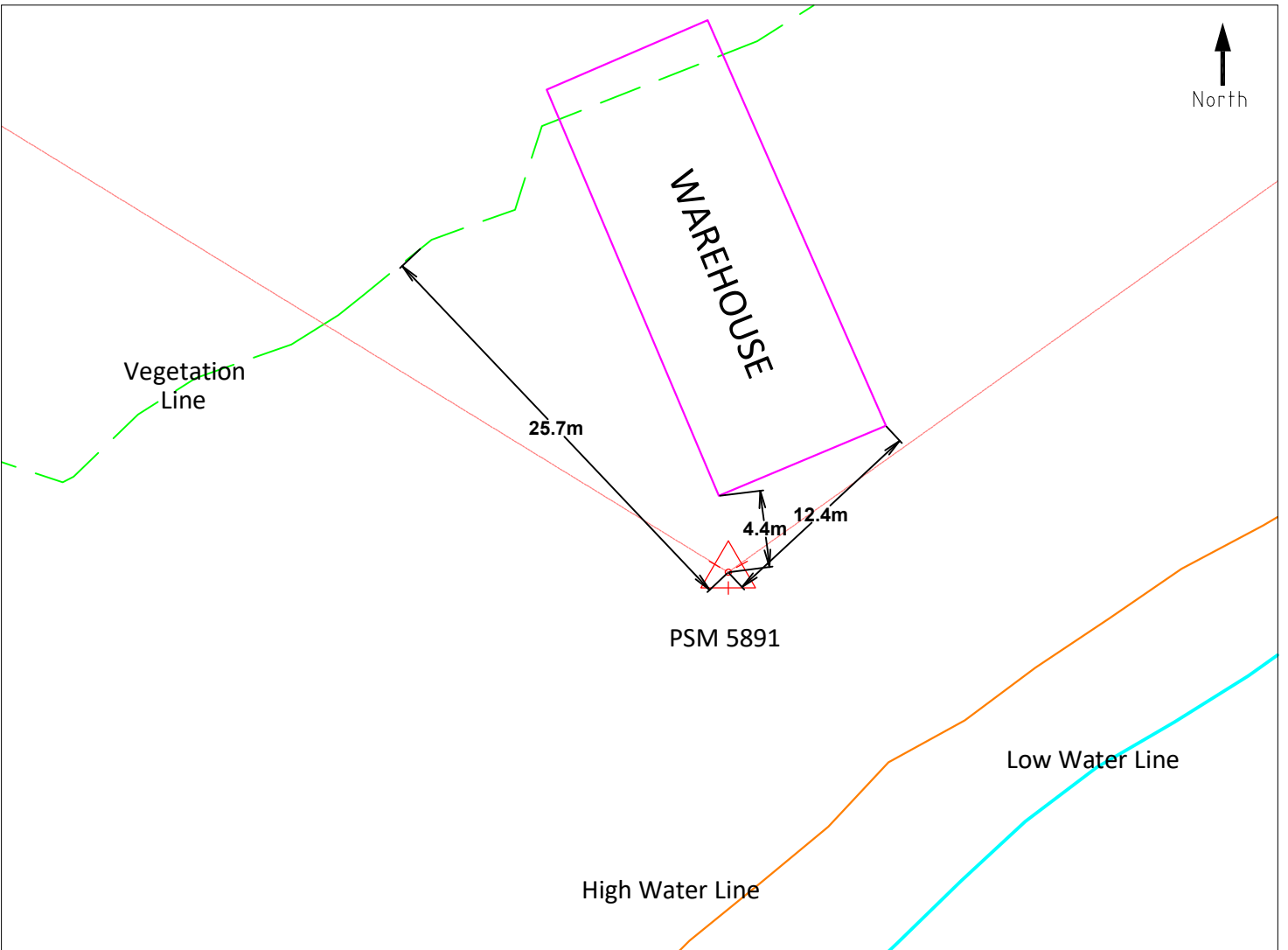

Sketched by: AHMED

Scale: Not to Scale

Date: 13 th February 2023

MALDIVES LAND SURVEY AUTHORITY

MINISTRY OF HOUSING AND INFRASTRUCTURE
Office (PABX): +(960) 3004300, Fax: +(960) 3004254
Email: survey@housing.gov.mv
Web: www.surveyofmaldives.gov.mv,
Ameenee Magu, Maafannu, Male', 20392, Maldives.



CONTROL POINT DETAILS	Station Number	PSM 5892
Coordinate Information		
Geodetic	Grid	
WGS 84	UTM Zone 43	
Lat: 5°26'34.28842"N	E: 345523.289m	
Long: 73°36'20.33044"E	N: 601795.793m	
Ellp Height: -106.926	Orth Height: +1.497	
Island Name: Lh.Meyyafushi, Maldives	Date: 13th February 2023	

Monument description & method of survey:

- Monument Type A as in Technical Brief
- Stainless steel plate fixed to concrete by Four bolts
- Horizontal coordinates fixed by GNSS Static survey.
- Elevation reduced relative to ellipsoid height difference reference to PSM 5891 which was corrected to Meanwater level by tide prediction table.
- PSM5892 is 0.38m above the ground Level

General site condition & access:

- Easily accessible area with wide angle of sky visibility
- Located at the North side of the island.
- Located next to the end of vegetation line of the island.
- Situated 2.60m away from the Vegetation line.

Owner: MUNI ENTERPRISES PVT LTD

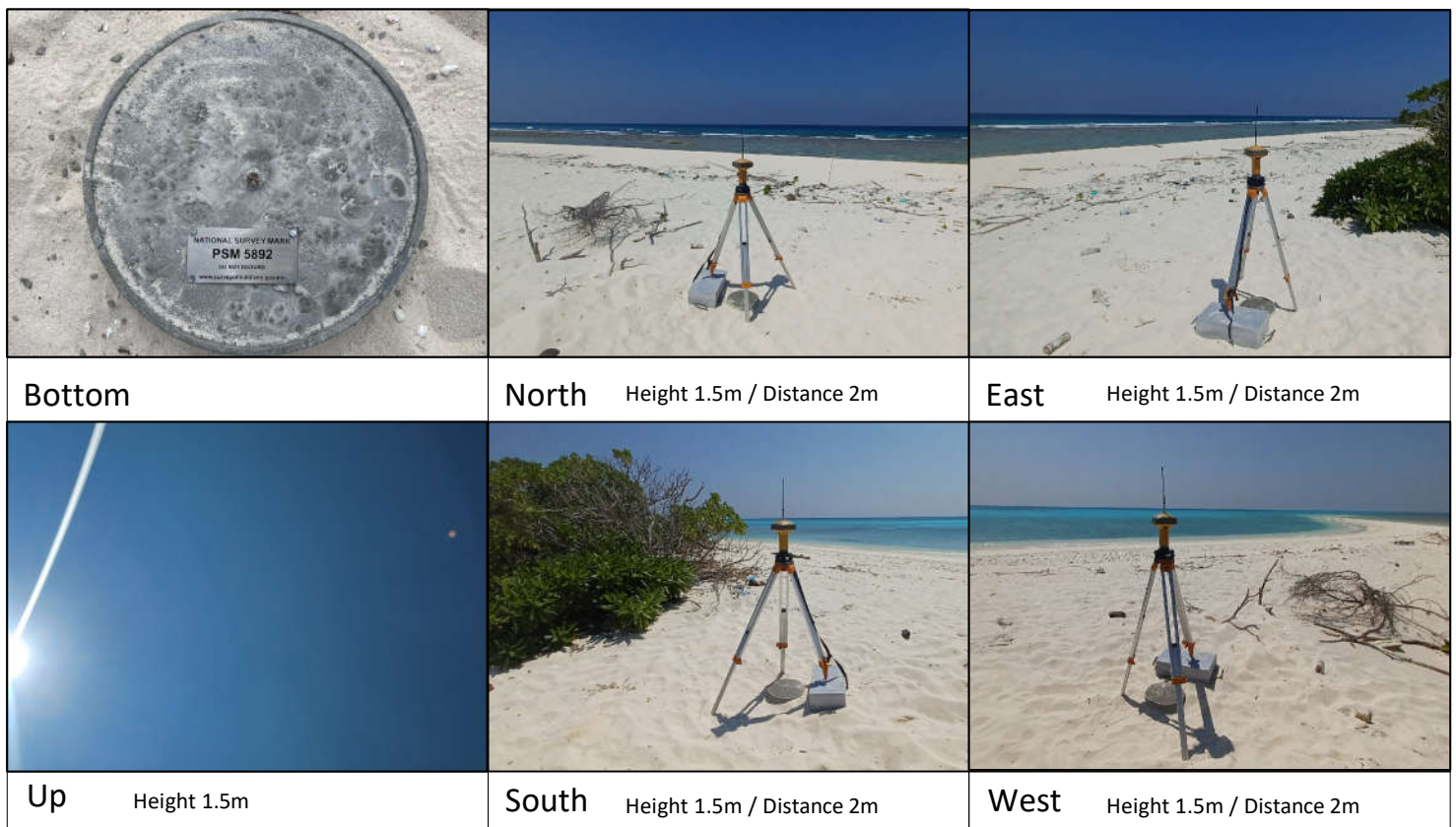

SITE INFORMATION

Station Number

P	S	M	5	8	9	2
---	---	---	---	---	---	---

Station Horizon Mask

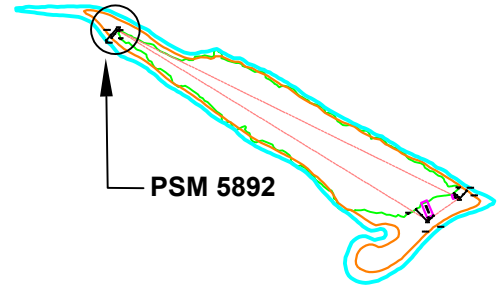
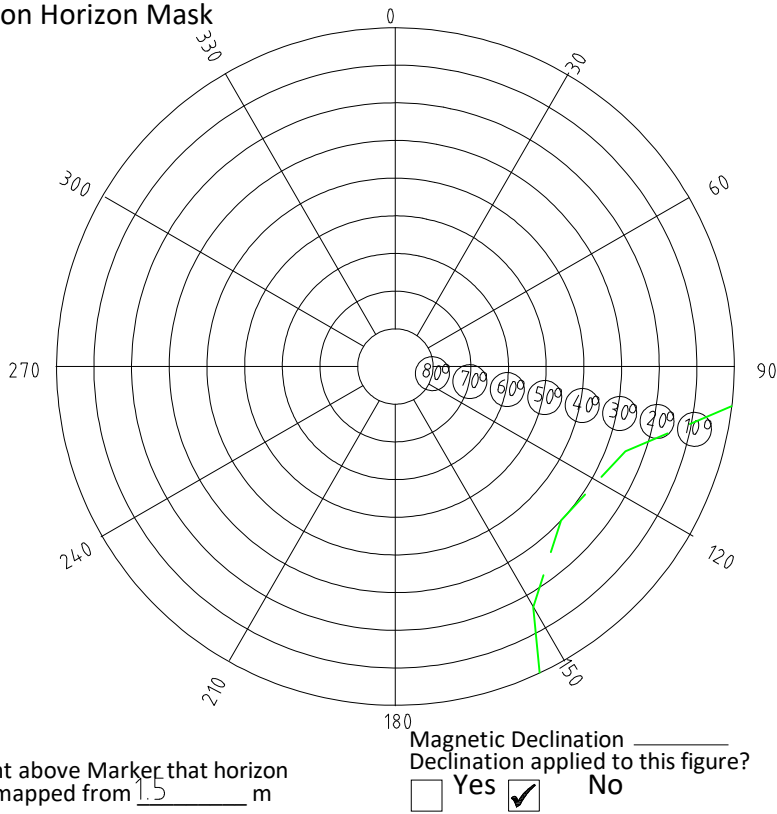

NOTE : THERE ARE NO SOLID STRUCTURES OR TREE AVAILABLE FOR MEASURING

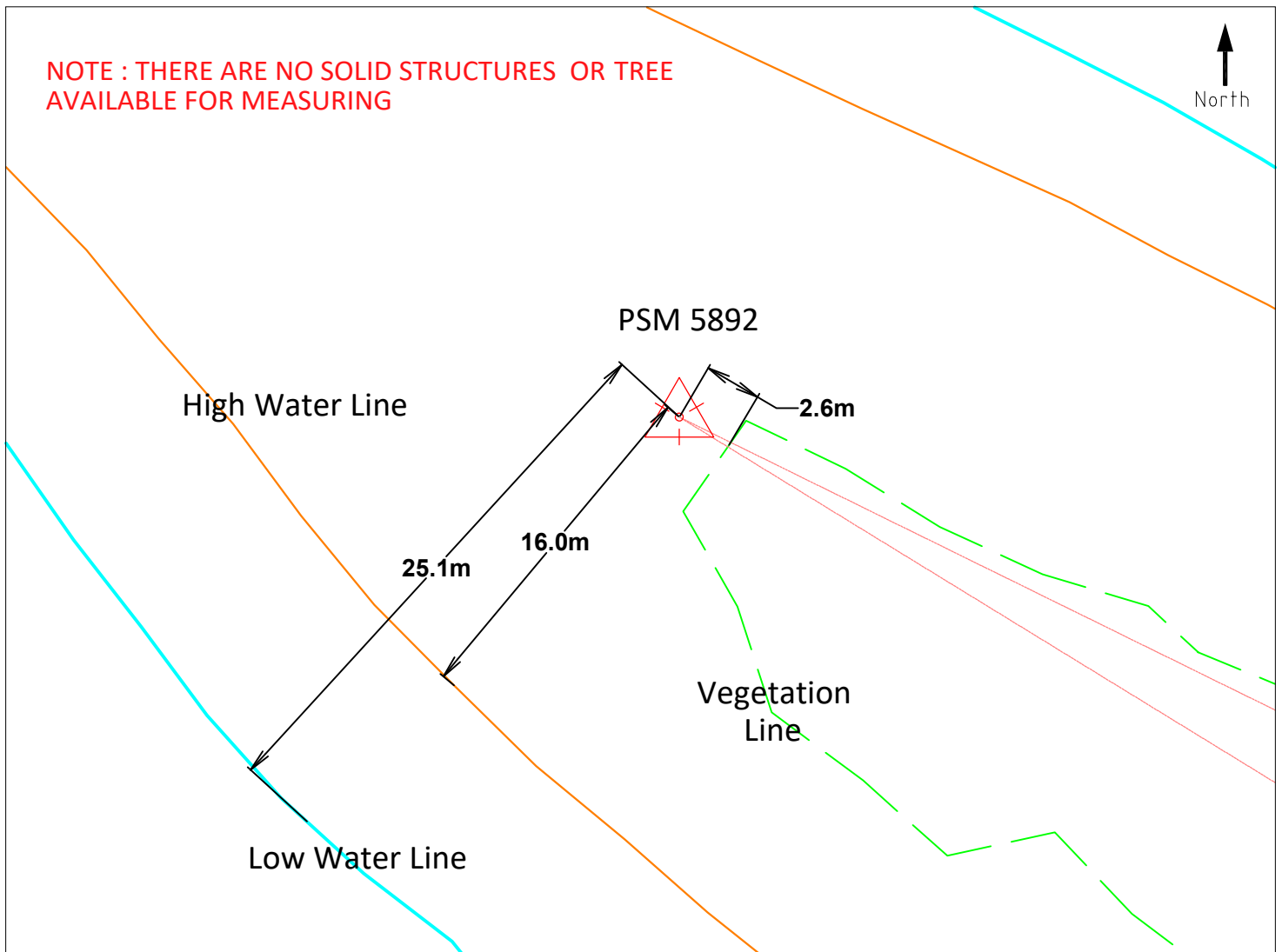

Sketched by: AHMED

Scale: Not to Scale

Date: 13 th February 2023